

# NBG4604

## Quick Start Guide

*Wireless N Gigabit Managed Router*

Version 1.00

Edition 2, 10/2010

### DEFAULT LOGIN DETAILS

LAN Port	LAN1 ~ LAN4
IP Address	http://192.168.1.1
Username	admin
Password	1234



### CONTENTS

ENGLISH	3
DEUTSCH	7
ESPAÑOL	11
FRANÇAIS	15
ITALIANO	19
SVENSKA	25
NEDERLANDS	29

# ZyXEL

# Connections

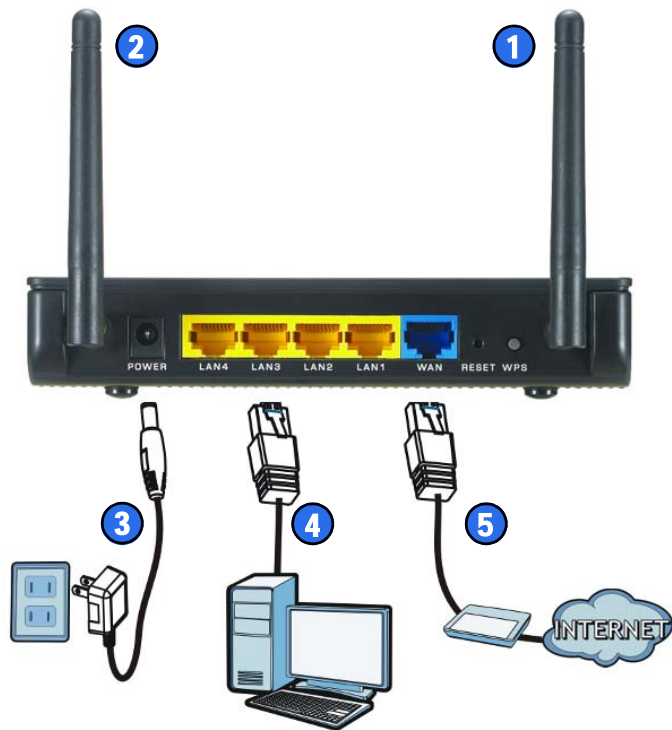

## LEDs

The following are descriptions of the NBG4604's LEDs:



*LEDs are green while on and connected to the network.*

- 1. Power:** Dark when the power is off or disconnected.
- 2. LAN 1~4:** Flashes when sending and receiving data, and dark when the connection is off or the cable is not connected or connected improperly.
- 3. WAN (Internet):** Flashes when sending and receiving data. Dark when the power is off, the connection is down or the cable is not connected or connected improperly.
- 4. Wireless:** Dark when the power is off, if the wireless LAN is not ready, or the connection has failed. Flashes when sending and receiving data.
- 5. WPS:** Dark when WPS is not configured. Green when it is configured. Flashes when negotiating a configuration.

# Connect to the NBG4604

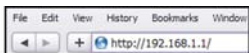

1 Connect to:  
`http://192.168.1.1`



2 Enter the default password of "1234", then change it when prompted.



3 Select a mode:  
**Wizard** or **Advanced**.

# Set Up Your Internet Connection

Connect to the NBG4604 then select **Wizard** mode:

**STEP 1** → STEP 2 → STEP 3

**System Information**

**System Name**

Enter a name to help you identify your router on the network. This information is optional and you may safely leave this field blank.

System Name:

**Domain Name**

The ISP's domain name is often sent automatically by the ISP to the router. If you are having difficulty accessing ISP services, you may need to enter the Domain Name manually in the field below. This field is normally left blank.

Domain Name:

**System Name:** Enter up to 30 characters for the device's name.

**Domain Name:** Leave this blank unless your ISP gave you this information.

**STEP 1** → **STEP 2** → STEP 3

**Wireless LAN**

**Wireless LAN**

The SSID is the name given to your wireless network. It may be possible to see multiple wireless networks from your home or office, so choose a name that you will be able to recognize later.

Name(SSID):

Security:

Channel Selection:   Auto Channel Selection

**Name (SSID):** Enter up to 30 characters for the network name as it appears to other wireless devices.

**Security:** Select a security type. The option selected here may require additional configuration.

**STEP 1** → STEP 2 → **STEP 3**

**Internet Configuration**

**ISP Parameters for Internet Access**

Enter your Internet Service Provider's (ISP) connection settings

Connection Type:

Service Name:  (optional)

User Name:

Password:

**Connection Type:** Select how you will connect to the Internet. This information is provided by your ISP. The options available here vary according to the selected connection type.

## Set Up a WPS Connection

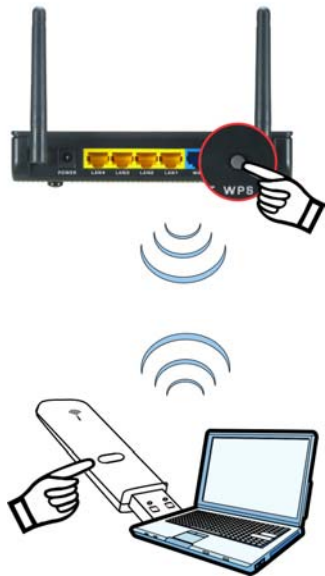

**1** Place the devices you want to connect near one another.

**2** Press the WPS button on the NBG4604.

The WLAN light blinks.

**3** Press the WPS button on a compatible device (such as the NWD-270N) within 2 minutes of pressing the button on the NBG4604.

The WLAN light on the NBG4604 shines steadily when connected.

For more information about the features described in this book, see the User's Guide on the included disc.

## LED-Anzeigen

Die LED-Anzeigen des NBG4604 haben die folgende Bedeutung:



*Die LED-Anzeigen leuchten grün, wenn das Gerät eingeschaltet ist und eine Verbindung zum Netzwerk besteht.*

1. **Power:** Leuchtet nicht, wenn das Gerät ausgeschaltet ist oder keine Verbindung besteht.
2. **LAN 1-4:** Die Anzeigen blinken, wenn Daten empfangen und gesendet werden. Sie leuchten nicht, wenn keine Verbindung besteht, das Kabel nicht oder nicht richtig angeschlossen ist.
3. **WAN (Internet):** Die Anzeige blinkt, wenn Daten empfangen und gesendet werden. Die Anzeige leuchtet nicht, wenn das Gerät ausgeschaltet ist, wenn keine Verbindung besteht oder das Kabel nicht oder nicht richtig angeschlossen ist.
4. **Wireless:** Leuchtet nicht, wenn das Gerät ausgeschaltet ist, wenn das drahtlose LAN nicht bereit ist oder keine Verbindung besteht. Die Anzeige blinkt, wenn Daten empfangen und gesendet werden.
5. **WPS:** Leuchtet nicht, wenn WPS nicht konfiguriert ist. Grün, wenn WPS konfiguriert ist. Blinkt beim Verhandeln einer Konfiguration.

# Anschließen an den NBG4604

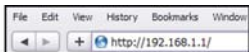

1 Verbinden mit:  
http://192.168.1.1



2 Geben Sie das Standard-Kennwort "1234" ein, und ändern Sie es nach Aufforderung.



3 Wählen Sie einen Modus: **Wizard** (Assistent) oder **Advanced** (Erweitert).



# Einrichten der Internetverbindung

Schließen Sie das Gerät an den NBG4604, und wählen Sie den Modus **Wizard** (Assistent):

**STEP 1** → STEP 2 → STEP 3

**System Information**

**System Name**

Enter a name to help you identify your router on the network. This information is optional and you may safely leave this field blank.

System Name:

**Domain Name**

The ISP's domain name is often sent automatically by the ISP to the router. If you are having difficulty accessing ISP services, you may need to enter the Domain Name manually in the field below. This field is normally left blank.

Domain Name:

## System Name (Systemname):

Geben Sie bis zu 30 Zeichen als Namen für das Gerät ein.

## Domain Name (Domainname):

Lassen Sie dieses Feld frei, wenn Ihnen der Internetdienstanbieter keinen Namen mitgeteilt hat.

**STEP 1** → **STEP 2** → STEP 3

**Wireless LAN**

**Wireless LAN**

The SSID is the name given to your wireless network. It may be possible to see multiple wireless networks from your home or office, so choose a name that you will be able to recognize later.

Name(SSID):

Security:

Channel Selection:   Auto Channel Selection

## Name (SSID):

Geben Sie die bis zu 30 Zeichen des Netzwerknamens ein, wie er anderen Drahtlosgeräten angezeigt wird.

## Security (Sicherheit):

Wählen Sie einen Sicherheitstyp. Die hier gewählt Option muss u.U. weiter konfiguriert werden.

**STEP 1** → **STEP 2** → **STEP 3**

**Internet Configuration**

**ISP Parameters for Internet Access**

Enter your Internet Service Provider's (ISP) connection settings

Connection Type:

Service Name:

User Name:

Password:

## Connection Type

(Verbindungstyp): Legen Sie fest, wie die Verbindung zum Internet hergestellt werden soll. Diese Information erhalten Sie von Ihrem Internetdienstanbieter. Die angezeigten Optionen hängen vom gewählten Verbindungstyp ab.

# Einrichten einer WPS-Verbindung

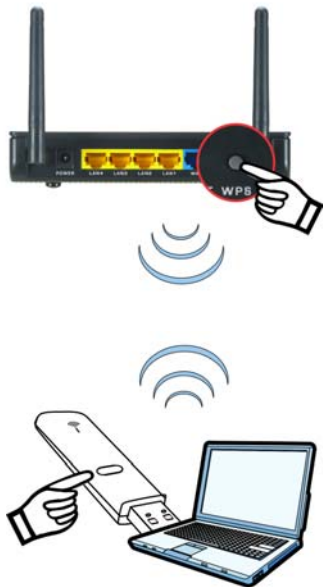

- 1 Stellen Sie alle Geräte, die angeschlossen werden sollen, nahe beieinander.
- 2 Drücken Sie auf die WPS-Taste des NBG4604.

Die WLAN-LED blinkt.

- 3 Drücken Sie innerhalb von 2 Minuten, nachdem Sie auf die Taste des NBG4604 gedrückt haben, auf die WPS-Taste eines kompatiblen Geräts (z.B. des NWD-270N).

Sobald die Verbindung besteht, leuchtet die WLAN-LED des NBG4604 dauerhaft.

Weitere Informationen zu den in diesem Benutzerhandbuch beschriebenen Funktionen finden Sie auf der mitgelieferten CD.

## LEDs

Descripción del estado de los LEDs del NBG4604:



Los LEDs se muestran en color verde cuando están encendidos y conectados a la red.

1. **Power:** Apagado cuando la corriente está apagada o desconectada.
2. **LAN 1~4:** Parpadea cuando se envían y reciben datos, y se apaga cuando la conexión está desactivada o si el cable no está conectado o está mal conectado.
3. **WAN (Internet):** Parpadea cuando se envían y se reciben datos. Apagado cuando la corriente está apagada, la conexión ha caído o si el cable no está conectado o está mal conectado.
4. **Wireless:** Apagado cuando la corriente está apagada, si la LAN inalámbrica no está lista o si la conexión ha fallado. Parpadea cuando se envían y se reciben datos.
5. **WPS:** Apagado cuando la WPS no está configurada. Verde cuando está configurada. Parpadea cuando negocia una configuración.

# Acceder al Configurador WEB

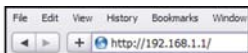

- 1 Abra un navegador web como Internet Explorer. Escriba "http://192.168.1.1" como se indica en la imagen.



- 2 Escriba la contraseña predeterminada "1234", luego cámbiela cuando se le pida.



- 3 Seleccione un modo: **Wizard** (Asistente) o **Advanced** (Avanzado).

# Configurar su conexión a Internet

Acceda al configurador Web de su NBG4604, y acceda seleccionando el modo Wizard (Asistente):

**STEP 1** → STEP 2 → STEP 3

**System Information**

**System Name**  
Enter a name to help you identify your router on the network. This information is optional and you may safely leave this field blank.  
System Name:

**Domain Name**  
The ISP's domain name is often sent automatically by the ISP to the router. If you are having difficulty accessing ISP services, you may need to enter the Domain Name manually in the field below. This field is normally left blank.  
Domain Name:

**System Name** (Nombre del sistema): Escriba hasta 30 caracteres para identificar la red inalámbrica de su router.

**Domain Name** (Nombre de dominio): Deje esto en blanco a menos que su ISP le haya facilitado la información.

**STEP 1** → **STEP 2** → STEP 3

**Wireless LAN**

The SSID is the name given to your wireless network. It may be possible to see multiple wireless networks from your home or office, so choose a name that you will be able to recognize later.

Name(SSID):

Security:

Channel Selection:   Auto Channel Selection

**Name (SSID)** (Nombre): Escriba hasta 30 caracteres para identificar la red inalámbrica de su router.

**Security** (Seguridad): Seleccione un tipo de seguridad. La opción seleccionada puede requerir configuración adicional.

**STEP 1** → **STEP 2** → **STEP 3**

**Internet Configuration**

**ISP Parameters for Internet Access**

Enter your Internet Service Provider's (ISP) connection settings

Connection Type:

Service Name:  (optional)

User Name:

Password:

**Connection Type** (Tipo de conexión): Seleccione cómo se conectará a Internet. Esta información es facilitada por su ISP. Las opciones disponibles aquí varían según el tipo de conexión seleccionado.

## Configurar una conexión WPS



**1** Coloque los dispositivos que desea conectar uno cerca del otro.

**2** Presione el botón WPS en el NBG4604.

La luz WLAN parpadeará.



**3** Presione el botón WPS en un dispositivo compatible (como el NWD-270N) dentro del periodo de 2 minutos tras haber presionar el botón WPS en el NBG4604.

La luz WLAN del NBG4604 se quedará fija tras conectarse.

Para más información acerca de las características descritas en este libro, consulte la Guía del usuario incluida en el disco.

## LEDs

Descriptions de la LED de NBG4604:



Les LED s'illuminent quand le routeur est connecté au réseau électrique et au réseau Ethernet.

- 1. Alimentation:** La LED est noire quand l'alimentation est éteinte ou déconnectée.
- 2. LAN 1 à 4:** Clignote pendant l'envoi et la réception des données, et noir si la connexion est interrompue, incorrecte ou si le câble n'est pas connecté.
- 3. WAN (Internet):** Clignote pendant l'envoi et la réception des données. La LED est noire si l'alimentation est éteinte, si la connexion est interrompue, incorrecte ou si le câble n'est pas connecté.
- 4. Sans fil:** La LED est noire si l'alimentation est éteinte, si le LAN sans fil n'est pas prêt ou si la connexion est défaillante. Clignote pendant l'envoi et la réception des données.
- 5. WPS:** Noir quand le WPS n'est pas configuré. Vert quand il est configuré. Clignotant lors de la négociation d'une configuration.

# Connecter au NBG4604

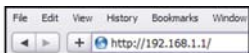

1 Connexion à:  
http://192.168.1.1



2 Entrez le mot de passe par défaut "1234", puis modifiez-le quand vous y êtes invité.



3 Sélectionnez un mode: **Wizard** (Assistant) ou **Advanced** (Avancé).



# Installez votre connexion Internet

Etablissez la connexion au NBG4604 puis sélectionnez le mode **Wizard** (Assistant):

**STEP 1** ← STEP 2 → STEP 3

**System Information**

**System Name**  
Enter a name to help you identify your router on the network. This information is optional and you may safely leave this field blank.  
System Name:

**Domain Name**  
The ISP's domain name is often sent automatically by the ISP to the router. If you are having difficulty accessing ISP services, you may need to enter the Domain Name manually in the field below. This field is normally left blank.  
Domain Name:

← Back Next → Exit

**System Name** (Nom du système): Entrez jusqu'à 30 caractères pour le nom du périphérique.

**Domain Name** (Nom du domaine): Laissez ce champ vide à moins que votre FAI vous ait donné cette information.

← STEP 1 → **STEP 2** → STEP 3

**Wireless LAN**

The SSID is the name given to your wireless network. It may be possible to see multiple wireless networks from your home or office, so choose a name that you will be able to recognize later.  
Name(SSID):

Security:  (w)

Channel Selection:   Auto Channel Selection

← Back Next → Exit

**Name (SSID)** (Nom (SSID)): Entrez jusqu'à 30 caractères pour le nom du réseau tel qu'il apparaît dans les autres périphériques sans fil.

**Security** (Sécurité): Sélectionnez un type de sécurité. L'option sélectionnée ici peut nécessiter une configuration supplémentaire.

STEP 1 ← STEP 2 → **STEP 3**

**Internet Configuration**

ISP Parameters for Internet Access

Enter your Internet Service Provider's (ISP) connection settings

Connection Type:  (optional)

Service Name:

User Name:

Password:

← Back Next →

**Connection Type** (Type de connexion): Choisissez votre mode de connexion à Internet. Cette information est fournie par votre FAI. Les options disponibles ici varient selon le type de connexion sélectionné.

## Etablir une connexion WPS

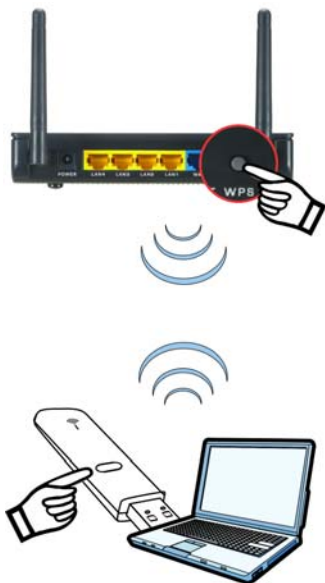

**1** Rapprochez les uns des autres les périphériques que vous voulez connecter.

**2** Appuyez sur le bouton WPS sur le NBG4604.

Le témoin lumineux WLAN clignote.

**3** Appuyez sur le bouton WPS sur un périphérique compatible (tel que le NWD-270N) dans les 2 minutes après avoir appuyé sur le bouton sur le NBG4604.

Le témoin lumineux WLAN sur le NBG4604 s'allume de façon fixe quand il est connecté.

Pour plus d'informations sur les fonctionnalités décrites dans ce livre, voir le guide de l'utilisateur sur le disque inclus.

Ce produit est conçu pour les bandes de fréquences 2,4 GHz et/ou 5 GHz conformément à la législation Européenne. En France métropolitaine, suivant les décisions n°03-908 et 03-909 de l'ARCEP, la puissance d'émission ne devra pas dépasser 10 mW (10 dB) dans le cadre d'une installation WiFi en extérieur pour les fréquences comprises entre 2454 MHz et 2483,5 MHz.

## LED

Di seguito vengono descritti i LED dell'NBG4604:



*I LED sono di colore verde quando il dispositivo è acceso e connesso alla rete.*

1. **Power** (alimentazione): Spento quando il dispositivo è spento o disconnesso.
2. **LAN 1 - 4**: Lampeggia quando vengono inviati e ricevuti dati, spento quando la connessione è disattivata o il cavo non è collegato o è collegato male.
3. **WAN (Internet)**: Lampeggia quando vengono inviati e ricevuti dati. Spento quando il dispositivo è spento, quando non c'è connessione oppure il cavo è scollegato o è collegato male.
4. **Wireless**: Spento quando il dispositivo è spento, quando la LAN wireless non è pronta oppure quando la connessione non è riuscita. Lampeggia quando vengono inviati e ricevuti dati.
5. **WPS**: Spento quando WPS non è configurato. Verde quando è configurato. Lampeggiante quando è in corso la negoziazione di una configurazione.

# Collegarsi a NBG4604

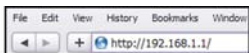

1 Collegarsi a:  
<http://192.168.1.1>



2 Inserire la password predefinita "1234", quindi modificarla quando viene richiesto.

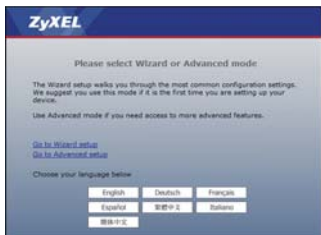

3 Selezionare una modalità: **Wizard** (Guidata) o **Advanced** (Avanzata).

# Configurazione della connessione a Internet

Collegarsi all'indirizzo NBG4604, quindi selezionare la modalità **Wizard** (Guidata):

**STEP 1** ← STEP 2 → STEP 3

**System Information**

**System Name**

Enter a name to help you identify your router on the network. This information is optional and you may safely leave this field blank.

System Name

**Domain Name**

The ISP's domain name is often sent automatically by the ISP to the router. If you are having difficulty accessing ISP services, you may need to enter the Domain Name manually in the field below. This field is normally left blank.

Domain Name

[Back](#) [Next >](#) [Exit](#)

**System Name** (Nome del sistema): inserire il nome del dispositivo, fino a un massimo di 30 caratteri.

**Domain Name** (Nome del dominio): lasciare vuoto questo campo a meno che il provider di servizi Internet non abbia fornito queste informazioni.

**STEP 1** ← **STEP 2** → STEP 3

**Wireless LAN**

The SSID is the name given to your wireless network. It may be possible to see multiple wireless networks from your home or office, so choose a name that you will be able to recognize later.

Name(SSID)

Security

Channel Selection   Auto Channel Selection

[Back](#) [Next >](#) [Exit](#)

**Name (SSID)** (Nome (SSID)): inserire il nome della rete come verrà visualizzato dagli altri dispositivi wireless, fino a un massimo di 30 caratteri.

**Security** (Sicurezza): selezionare il tipo di sicurezza. L'opzione selezionata potrebbe richiedere una configurazione aggiuntiva.

**STEP 1** ← **STEP 2** → **STEP 3**

**Internet Configuration**

**ISP Parameters for Internet Access**

Enter your Internet Service Provider's (ISP) connection settings

Connection Type  (optional)

Service Name

User Name

**Connection Type** (Tipo di connessione): selezionare il tipo di connessione a Internet. Questa informazione viene fornita dal provider di servizi Internet. Le opzioni disponibili variano a seconda del tipo di connessione selezionata.

# Configurazione di una connessione WPS

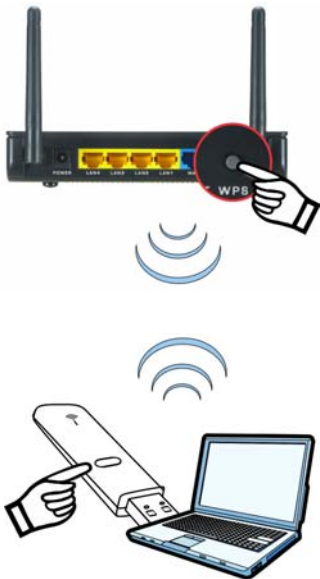

**1** Posizionare i dispositivi che si desidera collegare uno accanto all'altro.

**2** Premere il pulsante WPS sul dispositivo NBG4604.

La spia WLAN lampeggia.

**3** Premere il pulsante WPS su un dispositivo compatibile (ad esempio NWD-270N) mentre si preme per 2 minuti il pulsante dell'NBG4604.

La spia WLAN dell'NBG4604 brilla una volta stabilita la connessione.

Per maggiori informazioni sulle funzioni descritte in questo opuscolo, consultare il Manuale utente sul disco fornito in dotazione.

**"INFORMAZIONI AGLI UTENTI"**

**Ai sensi dell'art. 13 del Decreto Legislativo 25 luglio 2005, n.151 "Attuazione delle Direttive 2002/95/CE, 2002/96/CE e 2003/108/CE, relative alla riduzione dell'uso di sostanze pericolose nelle apparecchiature elettriche ed elettroniche, nonché allo smaltimento dei rifiuti"**



Il simbolo del cassonetto barrato riportato sull'apparecchiatura o sulla sua confezione indica che il prodotto alla fine della propria vita utile deve essere raccolto separatamente dagli altri rifiuti.

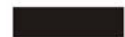

La raccolta differenziata della presente apparecchiatura giunta a fine vita è organizzata e gestita dal produttore. L'utente che vorrà disfarsi della presente apparecchiatura dovrà quindi contattare il produttore e seguire il sistema che questo ha adottato per consentire la raccolta separata dell'apparecchiatura giunta a fine vita.

L'adeguata raccolta differenziata per l'avvio successivo dell'apparecchiatura dismessa al riciclaggio, al trattamento e allo smaltimento ambientalmente compatibile contribuisce ad evitare possibili effetti negativi sull'ambiente e sulla salute e favorisce il reimpiego e/o riciclo dei materiali di cui è composta l'apparecchiatura.

Lo smaltimento abusivo del prodotto da parte del detentore comporta l'applicazione delle sanzioni amministrative previste dalla normativa vigente."





## Indikatorlampor

Här följer en beskrivning av NBG4604s indikatorlampor:



*Indikatorlamporna lyser gröna i påslaget läge och vid anslutning till nätverket.*

- 1. Ström:** Släckt när strömmen är frånslagen eller frånkopplad.
- 2. LAN 1~4:** Blinkar när data skickas och tas emot. Släckta när anslutningen är bortkopplad, när kabeln inte är ansluten eller när den är felaktigt ansluten.
- 3. WAN (Internet):** Blinkar när data skickas och tas emot. Släckt när strömmen är frånslagen, när anslutningen ligger nere, när kabeln inte är ansluten eller när den är felaktigt ansluten.
- 4. Trådlös:** Släckt när strömmen är frånslagen, om trådlöst LAN inte är redo eller om anslutningen misslyckades. Blinkar när data skickas och tas emot.
- 5. WPS:** Mörk när WPS inte är konfigurerad. Grön när den är konfigurerad. Blinkar medan konfigurering förhandlas.

# Anslut till NBG4604

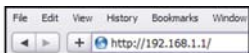

1 Anslut till:  
http://192.168.1.1



2 Skriv in standardlösenordet "1234", och ändra det därefter när du uppmanas att göra det.



3 Välj ett läge:  
**Wizard** eller **Advanced**.

# Anslut din internetanslutning

Anslut därefter till NBG4604 och välj läge **Wizard**:

**STEP 1** → STEP 2 → STEP 3

**System Information**

**System Name**

Enter a name to help you identify your router on the network. This information is optional and you may safely leave this field blank.

System Name:

**Domain Name**

The ISP's domain name is often sent automatically by the ISP to the router. If you are having difficulty accessing ISP services, you may need to enter the Domain Name manually in the field below. This field is normally left blank.

Domain Name:

← Back   Next >   Exit

**System Name** (Systemnamn): Fyll i upp till 30 tecken för enhetens namn.

**Domain Name** (domännamn): Lämna denna ruta tom, om du inte fått denna information av din ISP.

STEP 1 → **STEP 2** → STEP 3

**Wireless LAN**

**Wireless LAN**

The SSID is the name given to your wireless network. It may be possible to see multiple wireless networks from your home or office, so choose a name that you will be able to recognize later.

Name(SSID):

Security:  [v]

Channel Selection:   Auto Channel Selection

← Back   Next >   Exit

**Name (SSID)** (namn): Fyll i upp till 30 tecken för nätverksnamnet när det visas som andra trådlösa enheter.

**Security** (säkerhet): Välj en säkerhetstyp: Det valda alternativet kan kräva ytterligare konfiguration.

STEP 1 → STEP 2 → **STEP 3**

**Internet Configuration**

**ISP Parameters for Internet Access**

Enter your Internet Service Provider's (ISP) connection settings.

Connection Type:  [v]

Service Name:  (optional)

User Name:

Password:

← Back   Next >

**Connection Type** (Anslutningstyp): Välj hur du vill ansluta till internet. Denna information får du av din ISP. Tillgängliga alternativ beror på den valda anslutningstypen.

## Sätt upp en WPS-anlutning



- 1 Placera enheterna du vill ansluta i närheten av varandra.
- 2 Tryck på WPS-knappen på NBG4604.  
WLAN-lampan blinkar.



- 3 Tryck på WPS-knappen på en kompatibel enhet (som NWD-270N) inom 2 minuter efter du tryckt på knappen på NBG4604.  
WLAN-lampan på NBG4604 lyser när den är ansluten.

För mer information om funktionerna som beskrivs här, se användarmanualen på bifogad skiva.

## LED's

Betekenis van de LED's van de NBG4604:



*LED's zijn groen als het apparaat aanstaat en op het netwerk is aangesloten.*

- 1. Stroom:** Uit als de stroom uitstaat of afgesloten is.
- 2. LAN 1~4:** Knippert tijdens het verzenden en ontvangen van gegevens, en is uit als er geen aansluiting is of de kabel niet of onjuist is aangesloten.
- 3. WAN (Internet):** Knippert tijdens het verzenden en ontvangen van gegevens. Uit als er geen aansluiting is of de kabel niet of onjuist is aangesloten .
- 4. Draadloos:** Uit als er geen aansluiting is, als de draadloze LAN niet gereed is, of de aansluiting niet tot stand is gebracht. Knippert tijdens het verzenden en ontvangen van gegevens.
- 5. WPS:** Uit als de WPS niet is geconfigureerd. Groen als WPS is geconfigureerd. Knippert als er een configuratie wordt uitgevoerd.

# Verbinden met de NBG4604

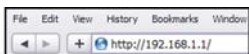

1 Verbinden met:  
http://192.168.1.1



2 Voer het standaardwachtwoord "1234" in en verander dit als u daarom gevraagd wordt.



3 Selecteer een modus: **Wizard** of **Advanced** (geavanceerd).

# Uw netwerkconfiguratie instellen

Sluit de NBG4604 aan en kies dan de **Wizard** modus:

**STEP 1** → STEP 2 → STEP 3

**System Information**

**System Name**

Enter a name to help you identify your router on the network. This information is optional and you may safely leave this field blank.

System Name:

**Domain Name**

The ISP's domain name is often sent automatically by the ISP to the router. If you are having difficulty accessing ISP services, you may need to enter the Domain Name manually in the field below. This field is normally left blank.

Domain Name:

**System Name** (Systeemnaam):  
Voer maximaal 30 tekens in voor de naam van het apparaat.

**Domain Name** (Domeinnaam):  
Laat dit veld leeg, tenzij uw ISP deze informatie heeft opgegeven.

**STEP 1** → **STEP 2** → STEP 3

**Wireless LAN**

**Wireless LAN**

The SSID is the name given to your wireless network. It may be possible to see multiple wireless networks from your home or office, so choose a name that you will be able to recognize later.

Name(SSID):

Security:

Channel Selection:   Auto Channel Selection

**Name (SSID)** (Naam(SSID)):  
Voer maximaal 30 tekens in voor de netwerknaam zoals deze voor andere draadloze apparaten te zien is.

**Security** (Beveiliging):  
Selecteer een beveiligingstype. De geselecteerde optie kan tot verdere configuratie leiden.

**STEP 1** → **STEP 2** → **STEP 3**

**Internet Configuration**

**ISP Parameters for Internet Access**

Enter your Internet Service Provider's (ISP) connection settings

Connection Type:

Service Name:  (optional)

User Name:

Password:

**Connection** (Verbinding) **Type**:  
Kies de manier waarop u met Internet verbonden wilt worden. Deze informatie wordt door uw ISP gegeven. De beschikbare opties zijn afhankelijk van het geselecteerde verbindingstype.

## Instellen van een WPS verbinding



**1** Plaats de apparaten die u wilt verbinden naast elkaar.

**2** Druk op de WPS knop op de NBG4604.

Het WLAN lampje gaat knipperen.



**3** Druk op de WPS knop van het compatibele apparaat (zoals de NWD-270N) binnen 2 minuten nadat u de knop op de NBG4604 heeft ingedrukt.

Het WLAN lampje op de NBG4604 zal blijven branden als de verbinding tot stand is gekomen.

Voor meer informatie over de kenmerken die in dit boekje worden beschreven leest u de Gebruikershandleiding op de bijgeleverde disk.



## Declaration of Conformity

We, ZyXEL Communications Corp., located at No.6, Innovation Rd II, Science-Park, Hsin-Chu, 300, Taiwan, declare under our sole responsibility that the product:

### Product information

Product Name : Wireless N Gigabit Managed Router

Model Number : NBG4604

### Produced by

Company Name : ZyXEL Communications Corporation

Company Add. : No. 6, Innovation Road II, Science-Park, Hsin-Chu, 300, Taiwan

to which this declaration relates, is in conformity with the following standards or other normative documents:

**EN 301489-17 V2.1.1 (2009-05)**

**EN 301489-1 V1.8.1 (2008-04)**

**EN 55022: 2006+A1: 2007**

**EN 61000-3-2: 2006**

**EN 61000-3-3: 2008**

**EN 55024:1998+A1:2001+A2:2003**

**Safety EN 60950-1: 2006+A11: 2009**

**EN 300328 V1.7.1 (2006-10)**

**EN 50385: 2002**

**COMMISSION REGULATION (EC)**

**No 1275/2008**

**COMMISSION REGULATION (EC)**

**No 278/2009**

Following the provisions of 2004/108/EC; 92/31/EEC Directive; 93/68/EEC, 99/5/EEC, LVD 2006/95/EC, and EuP 2005/32/EC.

In accordance with Annex III of the Directive 1999/5/EC.

The TCF-File is located at:

Company Name : ZyXEL Communications Czech s.r.o.

Company Address : Modranska 621, 143 01 Praha 4, Czech Republic

Person is responsible for marking this declaration:

Milan Baran

Name (Full Name)

















2010-04-23

Date

VP Operations

Position/ Title

Legal Signature

ENGLISH	DEUTSCH	ESPAÑOL	FRANÇAIS
<p>Green Product Declaration RoHS Directive 2002/95/EC</p>   <p>WEEE Directive 2002/95/EC (WEEE: Waste Electrical and Electronic Equipment) 2003/108/EC</p> <p>Declaration Signature: <i>Alan Cho</i></p> <p>Name/Title: Alan Cho / Quality Assurance Director Date (aaaa/mm/dd): 2009/3/24</p>	<p>Green Product Declaration RoHS Directive 2002/95/EC</p>   <p>WEEE Directive 2002/95/EC (WEEE: Waste Electrical and Electronic Equipment) 2003/108/EC</p> <p>Unterschrift des Erklärenden: <i>Alan Cho</i></p> <p>Name/Title: Alan Cho / Quality Assurance Director Datum (JJJJ/MM/TT): 2009/3/24</p>	<p>Declaración de Producto Ecológico Directiva RoHS 2002/95/EC</p>   <p>Directiva REEE 2002/95/EC (REEE: Residuos de Equipos Eléctricos y Electrónicos) 2003/108/EC</p> <p>Firma de declaración: <i>Alan Cho</i></p> <p>Nombre/Título: Alan Cho / Quality Assurance Director Fecha (aaaa/mm/dd): 2009/3/24</p>	<p>Déclaration de Produit Green Directive RoHS 2002/95/EC</p>   <p>Directive DEEE 2002/95/EC (DEEE: Déchets des Equipements Electriques et Electroniques) 2003/108/EC</p> <p>Signature de la déclaration: <i>Alan Cho</i></p> <p>Nom/Title: Alan Cho / Quality Assurance Director Date (aaaa/mm/jj): 2009/3/24</p>
<p>ITALIANO</p> <p>Dichiarazione Green Product Direttiva RoHS 2002/95/CE</p>   <p>Direttiva RAEE 2002/95/CE (RAEE: Rifiuti di Apparecchiature Elettriche ed Elettroniche) 2003/108/CE</p> <p>Firma dichiarazione: <i>Alan Cho</i></p> <p>Nome/Titolo: Alan Cho / Quality Assurance Director Data (aaaa/mm/gg): 2009/3/24</p>	<p>NEDERLANDS</p> <p>Productmilieuverklaring RoHS-richtlijn 2002/95/EC</p>   <p>AEEA-richtlijn 2002/95/EC (AEEA: Afgedankte Elektrische en Elektronische Apparaten) 2003/108/EC</p> <p>Verklaringhandtekening: <i>Alan Cho</i></p> <p>Naam/Titel: Alan Cho / Quality Assurance Director Datum(jjjj/mm/dd): 2009/3/24</p>	<p>SVENSKA</p> <p>Miljödeklaration RoHS Direktiv 2002/95/EC</p>   <p>WEEE Direktiv 2002/95/EC (WEEE: hantering av elektriskt och elektroniskt avfall) 2003/108/EC</p> <p>Deklaration undertecknad av: <i>Alan Cho</i></p> <p>Namn/Titel: Alan Cho / Quality Assurance Director Datum (åååå/mm/dd): 2009/3/24</p>	<p>FRANÇAIS</p> <p>Déclaration de Produit Green Directive RoHS 2002/95/EC</p>   <p>Directive DEEE 2002/95/EC (DEEE: Déchets des Equipements Electriques et Electroniques) 2003/108/EC</p> <p>Signature de la déclaration: <i>Alan Cho</i></p> <p>Nom/Title: Alan Cho / Quality Assurance Director Date (aaaa/mm/jj): 2009/3/24</p>